

Ottobrunn

State Road St 2078 (Rosenheimer Landstrasse)

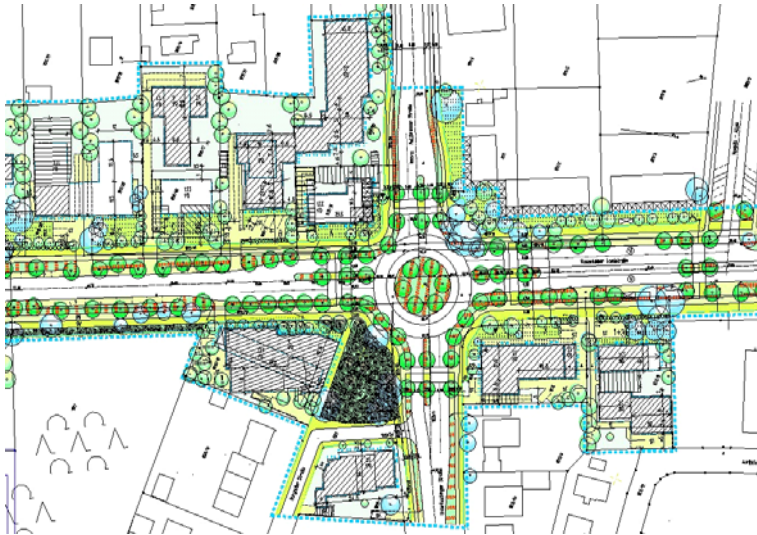

Client

Straßenbauamt München
[Munich Road Construction
Authority]

Period

since 1981

Project Cost

10.000.000 €

Abstract

Rosenheimer highway in the transit road to Ottobrunn is significant not only for the district's exterior connections (St 2078 Munich-Rosenheim), but also for buses and the interior traffic. The development should consider traffic requirements as well as urbanistic objectives, like revaluation of road area through constant planting measures for avenues.

For adjustment to functional requirements, the road width was divided in four sections between 22 and 30,75 m. Additionally, traffic circles were planned for two important nodal points to improve the traffic flow and visual reference points.

Scope of Service

pre-design, design, approval design,
execution design, preparation of tender
documents, construction supervision,
documentation, site supervision

inventory

Technical Data

Extension of the transit area

Munich–Rosenheim approx. 3,000 m

Road width 7.50 m at 22.00 to 30.75 m

Traffic circles at dominant crossroads 2