

Berlin

Berlin Brandenburg International Airport Supply and Disposal Networks

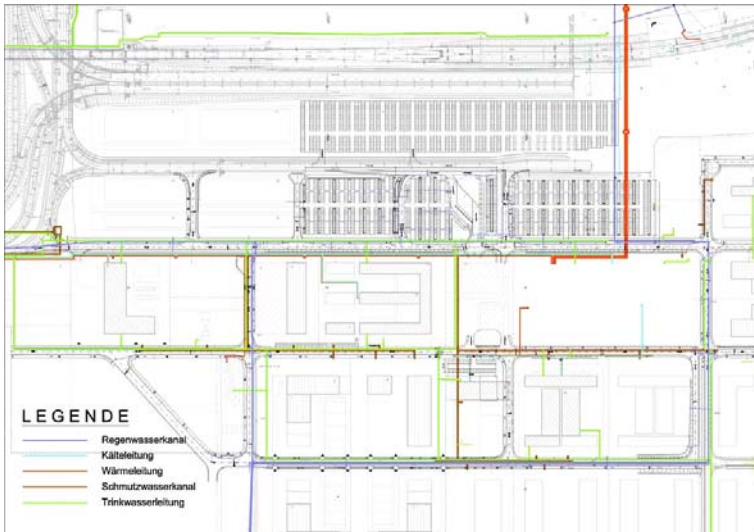

Client

ARGE BBI GU XI Ver- und
Entsorgung [ARGE BBI GU XI
Supply and Disposal]

Period

since 2007

Project Cost

25.000.000 €

Abstract

Construction works for the new Berlin Brandenburg International (BBI) started in September 2006. One of the first constructional measures was creation of the building infrastructure as well as taxiway connections to the northern runway.

The airport will start operating end of 2011. In connection with the terminal operation start in mid 2008, the entire supply and disposal networks for buildings as well as drainage of the paved areas shall be carried out. For this purpose, Schlegel Consulting Engineers has been working out, within a consortium, the design and execution planning of potable and quench waters, long-distance heating and cooling, as well as stormwater- and wastewater pipelines for partial areas of the airport.

Scope of Service

design, execution design

formwork and reinforcement drawings
coordination of the supply system
preparation of contract awarding
technical equipment, part IX: preliminary-
and detailed design

Technical Data

Potable-/fire water pipelines	Nodular iron up to DN 400 Length of approx. 16,000 m
Long-distance heating pipes	Isolated steel pipe up to DN 250 Length of approx. 17,500 m
Long-distance cooling pipes	Isolated steel pipe up to DN 500 Length of approx. 7,600 m
Storm water pipes	Ferroconcrete up to DN 2400 Length of approx. 6,150 m
Wastewater pipes	Stoneware up to DN 500 Length of 4,200 m PEHD up to DN 100, Length of 1,600 m Nodular iron up to DN 400, Length of 7,000 m