

# Lindau

## Flood Protection Motzacher Tobelbach Extension/Discharge

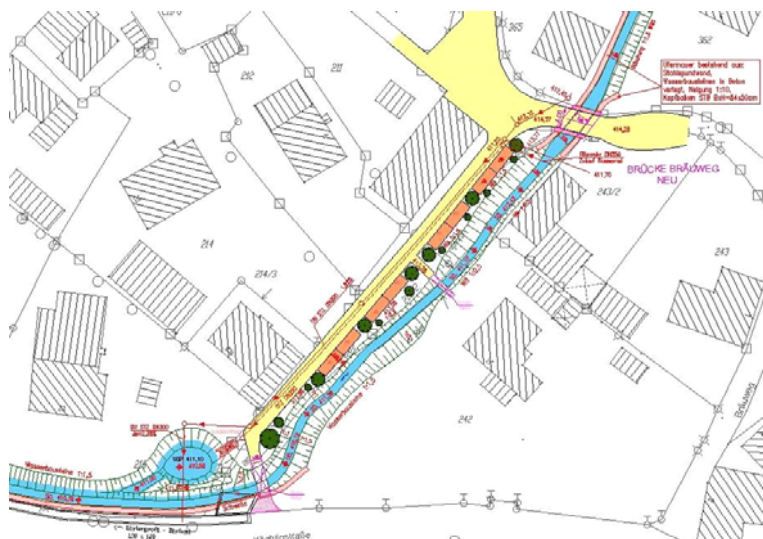

Regierungsbaumeister  
**SCHLEGEL**



### Client

Stadt Lindau [City of Lindau]

### Period

since 2004

### Project Cost

6.400.000 €

### Abstract

In an integrated concept for upper reaches of Lindauer Ach, the city of Lindau planned improvement of flood protection measures by implementing flood retention tanks, construction and extension of the river Motzacher Tobelbach as well as extension of the river Lindauer Ach in the city of Lindau.

Flood retention was not possible in the upper reaches of Motzacher Tobelbach. As a result, Motzacher Tobelbach was naturally extended and a new waterway was created for relief of Lindauer Ach and the discharge to Lake Constance.

### Scope of Service

pre-design, design, approval design  
planning of structural framework

hydraulic calculation  
urban, rural and lake landscape planning  
measurement by IB Zimmermann  
ground survey through south construction site

### Technical Data

#### Extension of Motzacher Tobelbach

HQ <sub>100</sub>	6.5 m <sup>3</sup> /s
Close-to-nature extension length	870 m
Embankment	990 m
Bank wall	750 m
4 bridges, 5 site transits, 3 footbridges	

#### Motzacher Tobelbach

HQ <sub>100</sub>	4.0 m <sup>3</sup> /s
Close-to-nature extension length	770 m
Embankment	500 m
Open trough	180 m
Closed trough	90 m
2 bridges, 1 site transit	