

Landshut

Hydrodynamic Sewer Simulation Pollution Load Calculation

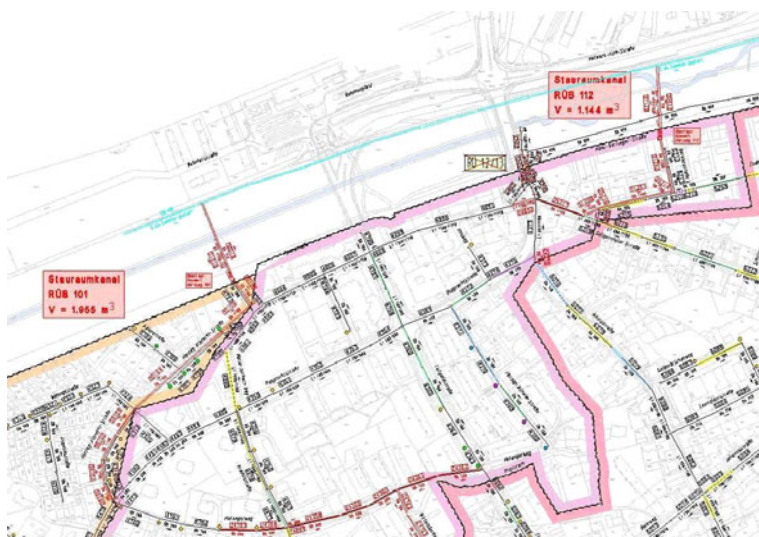

Regierungsbaumeister
SCHLEGEL



Client

Stad Landshut / Stadtwerke
[City of Landshut / Public
Services]

Period

2002 - 2006

Project Cost

not specified

Abstract

The entire catchment area of Landshut sewage treatment plant comprises the sewage network of the city of Landshut as well as the connected municipalities of Altdorf and Ergolding. The sewage network with a total length of 498 km, including 80% combined wastewater and 20% separate systems, was dimensioned hydrodynamically with regard to its current state and future prospects. The combined wastewater discharge systems were checked again and redimensioned, based on a collective model with pollution load calculations. Measurements were in line with various data gathered about pipelines, which were finally worked out into a common data record. Programmes such as Barthauer BASYS for GIS-system, SFBS for hydrodynamic- and SMUSI 4.0 for pollution load calculations were applied.

Scope of Service

hydrodynamic calculation of sewer networks
pollution load calculation
water law procedures

Technical Data

Pipeline length	498 km
Storm water retention tanks	1
Storm water overflow	9
Storm water tanks with overflow	14
Sewers with storage capacity	11
Available storage volume	14,697 m ³
Sewer network	13,840 m ³
Pumping stations	2